

# ALPIN CD56

## TECHNICAL CHARACTERISTICS:

Frame Face Width : 56mm

Basic depth : 42mm

Transom Minimum width : 80mm

Maximum Height up to 2.7m

Weight up to 130kg

Infill Thickness : up to 33mm

Wide range of hardware including

Multi-point lock (Optional)

QUA`LICOAT certified powder coating



The ALPIN CD56 aluminum door system is carefully designed to meet a variety of needs, offering a blend of elegance and timeless style. It is fully compatible with ALPIN CW56 and includes options for both outward-opening applications and swing doors.

This cost-effective system provides a low-price solution for any casement door application, whether internal or external. Combining sophistication with practicality, the ALPIN CD56 is a versatile choice that delivers both value and high performance.

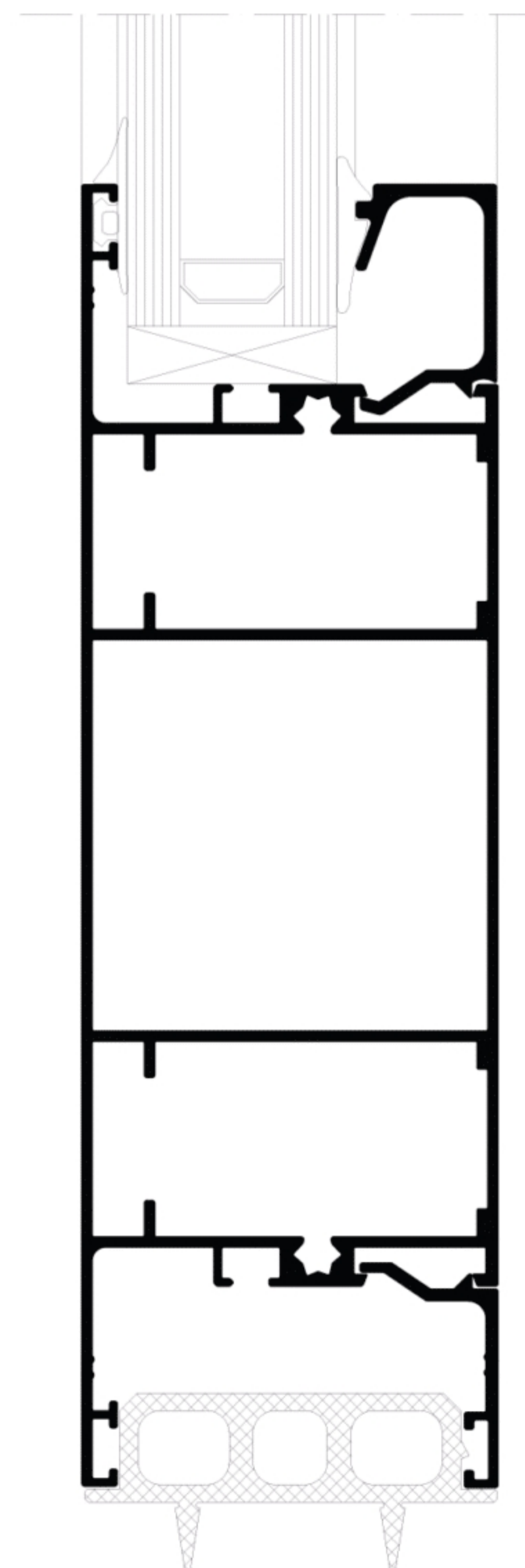
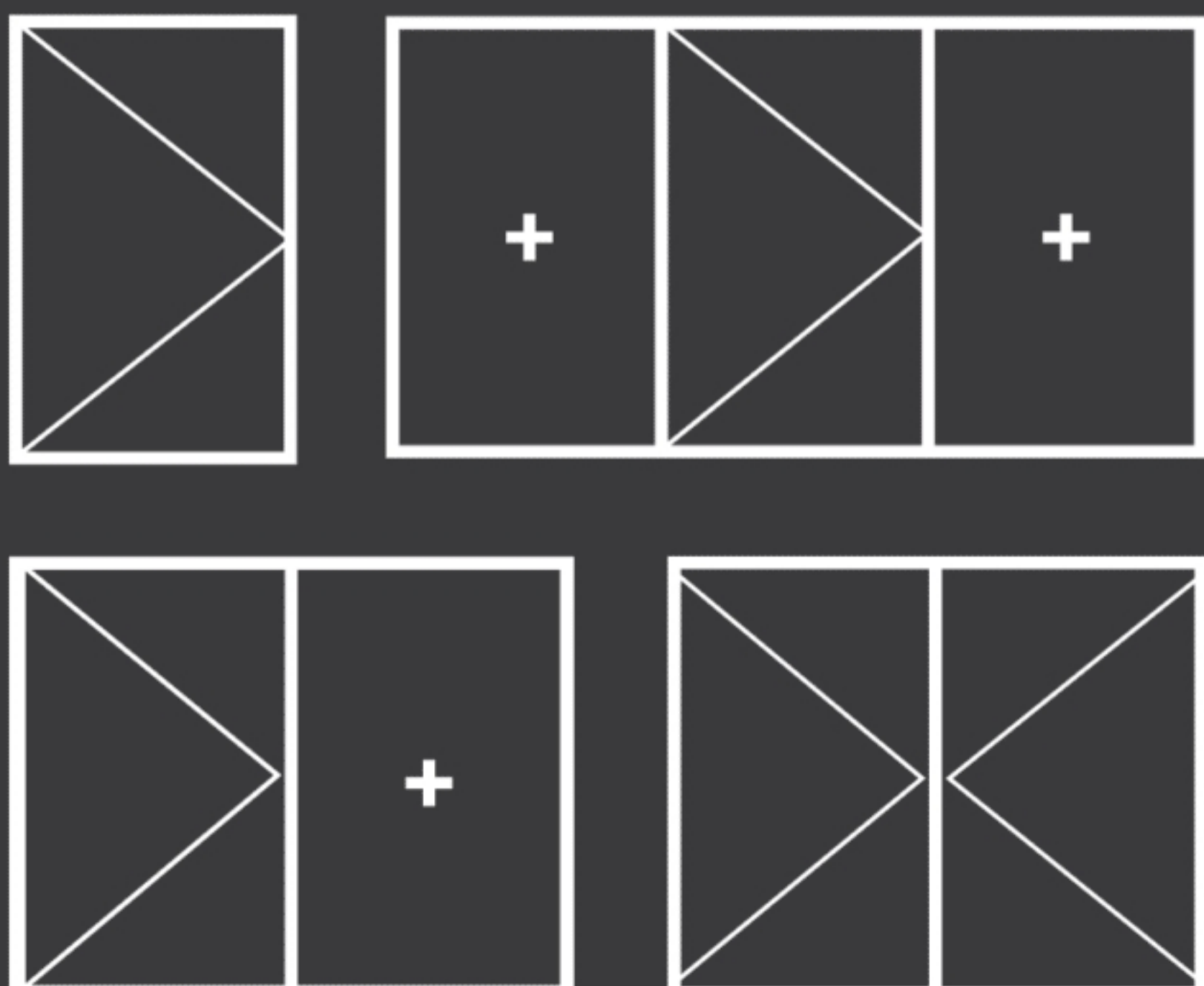

# ALPIN CDI75

## TECHNICAL CHARACTERISTICS:

Thermally Insulated profiles

Frame Face Width : 75mm

Basic depth : 92mm

Threshold : 16mm

Maximum Height up to 2.7m

Weight up to 100kg

Infill Thickness : up to 39mm

Uf : 3.2 W/(m<sup>2</sup>·K)

Premium EPDM glazing wedges

QUA`LICOAT certified powder coating

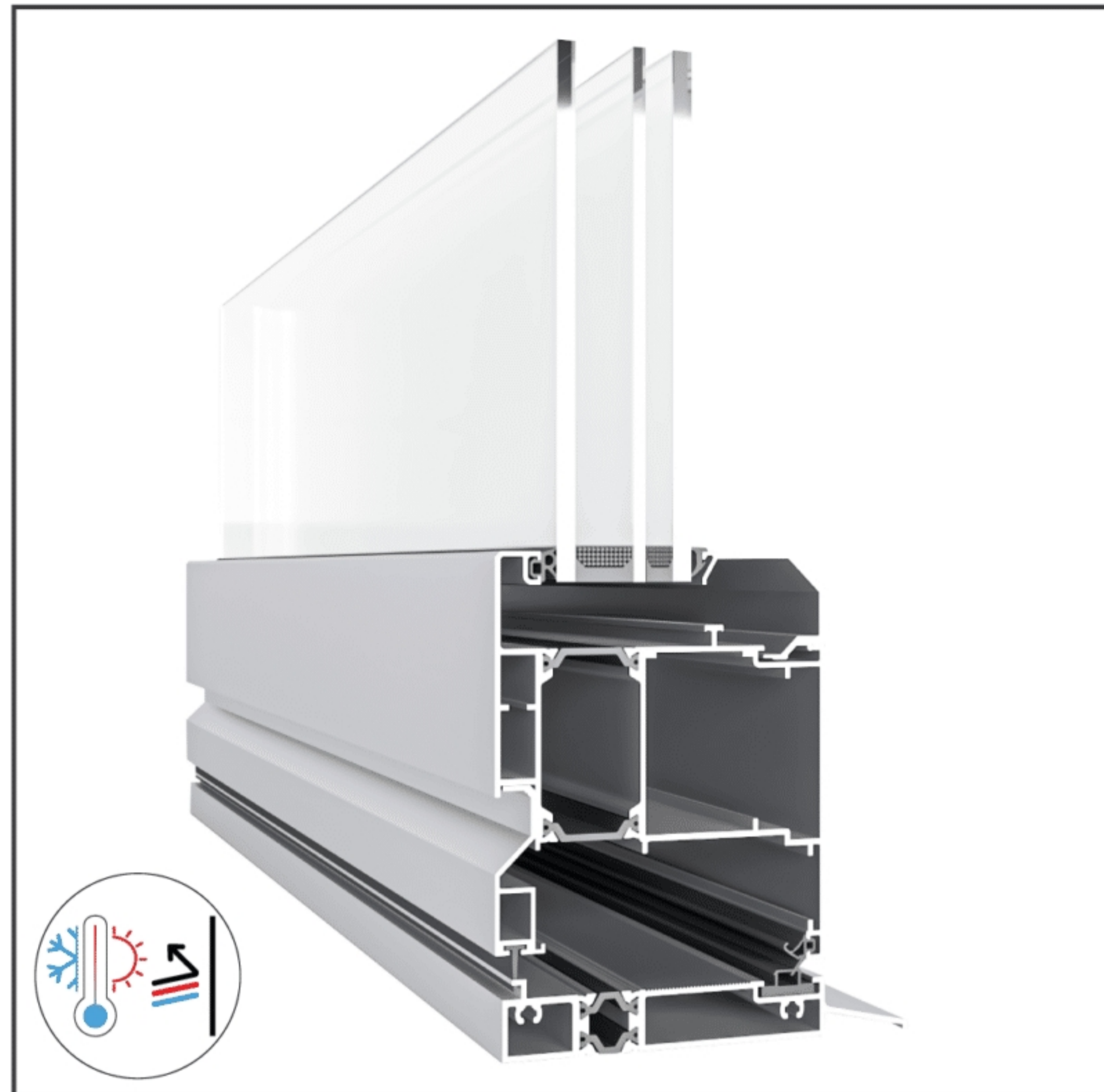

The standard door system offers exceptional stability and an elegant design that balances quality and cost-effectiveness. Ideal for heavy-duty and energy-efficient constructions, it features thermally insulated design for enhanced energy efficiency and design flexibility in sustainable architecture.

Meeting top performance standards, this door system excels in thermal insulation and sound reduction. Its distinctive design integrates seamlessly with the curtain wall system FUI70s, combining ease of use and high functionality with superior security, making it perfect for demanding markets.

